

**ROOFING, MASONRY,
AND EXTERIOR METALS
ADDENDUM NO: 02**

CarterWatkins Associates
Architects, Inc.
137 E. Washington Street
Monroe, Georgia 30655

**PROJECT: THE NEW DALLAS, GEORGIA CITY HALL
ROOFING, MASONRY AND EXTERIOR METALS
PACKAGE**

DATE OF ISSUE: 11.22.2024

This addendum modifies the Contract Documents only in the manner and to the extent stated herein and shown on any accompanying drawings and will become a part of the Contract Documents. Except as specified or otherwise indicated by this addendum, all work shall be in accordance with the basic requirements of the Contract Documents.

PROPOSER SHALL ACKNOWLEDGE RECEIPT OF ADDENDUM IN A SPACE PROVIDED ON THE BID PROPOSAL FORM; FAILURE TO DO SO MAY CONSTITUTE AN INFORMALITY IN THE PROPOSAL.

The following clarifications, amendments, additions, revisions, changes and/or modifications shall take precedence over the drawings and specifications for the above-named project only in the amount and to the extent hereinafter specified in this addendum. Where any item called for in the specifications or indicated on the drawings is not supplemented hereby, the original requirements shall remain in effect. Where any original item is amended, voided or superseded hereby, the provision of such item not specifically amended, voided or superseded shall remain in effect.

Item #1: Please see the attached drawing in reference to the exterior masonry (stone/brick) steps referenced in addendum one, item eight, number two. The drawing is to be used for pricing this portion of the project.

Item #2: Please include within your bid package:

- A list of five similar projects with defined scope of work and date completed. For each example list:
 - Project
 - Address
 - Date
 - Owner's name and contact
 - Estimated cost
 - Detail type of roof, any masonry and metal work
- Five professional references, with connection to reference and contact information (phone and email)

END OF ADDENDUM NO: 02

Nov 18 2024 1: E:\DW\Projects\2021\Paulling County Courthouse (Dallas City Hall)\Paulling County Courthouse\Sheet\A-301 ENLARGED HANDICAP RAMP DETAIL.dwg



2 STEPS ELEVATIONS
1/2" = 1'-0"

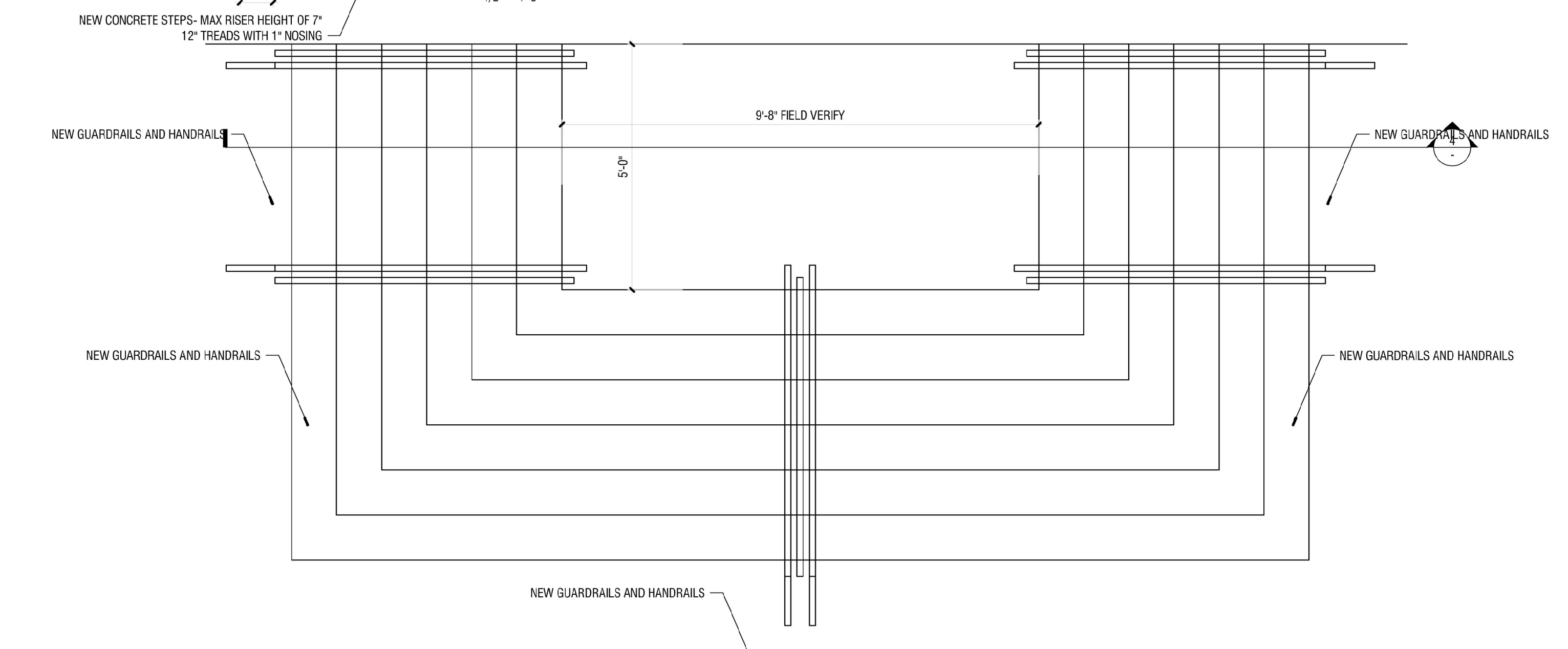

1 STEPS PLAN VIEW
1/2" = 1'-0"

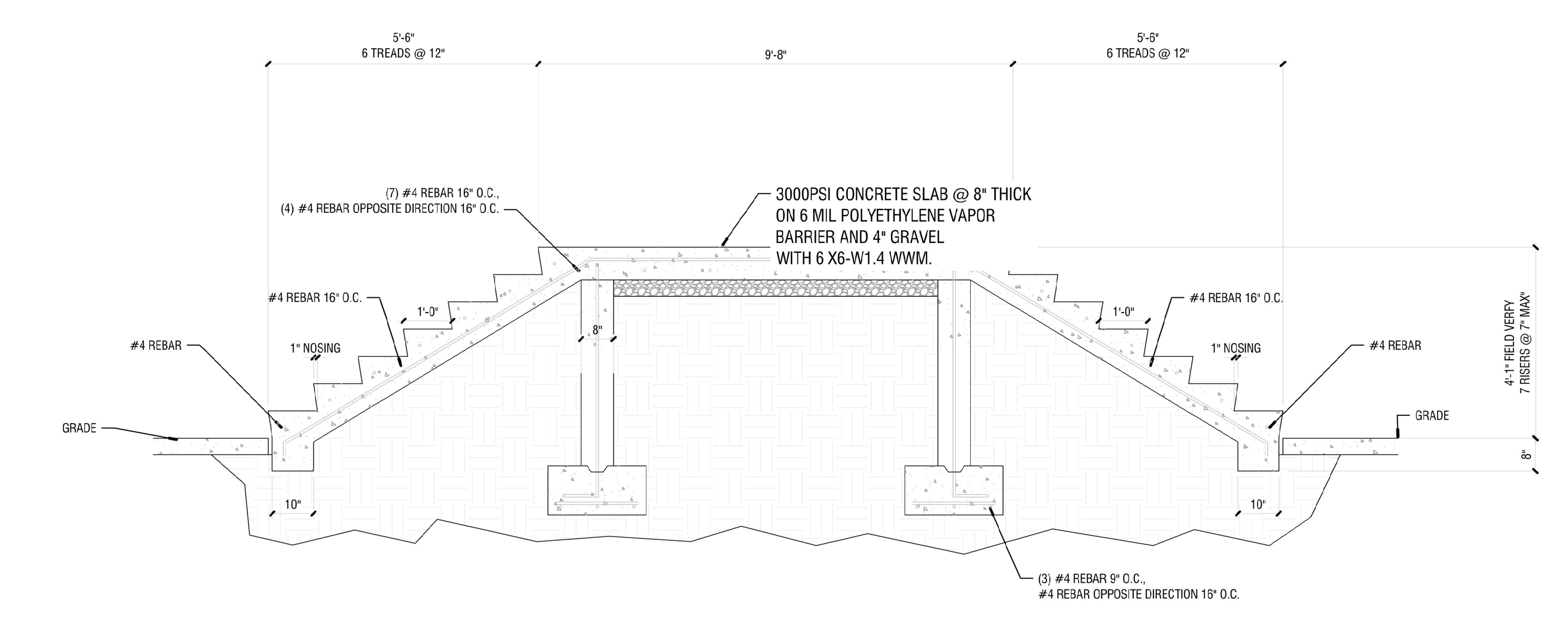

4 STEPS SECTION
1" = 1'-0"

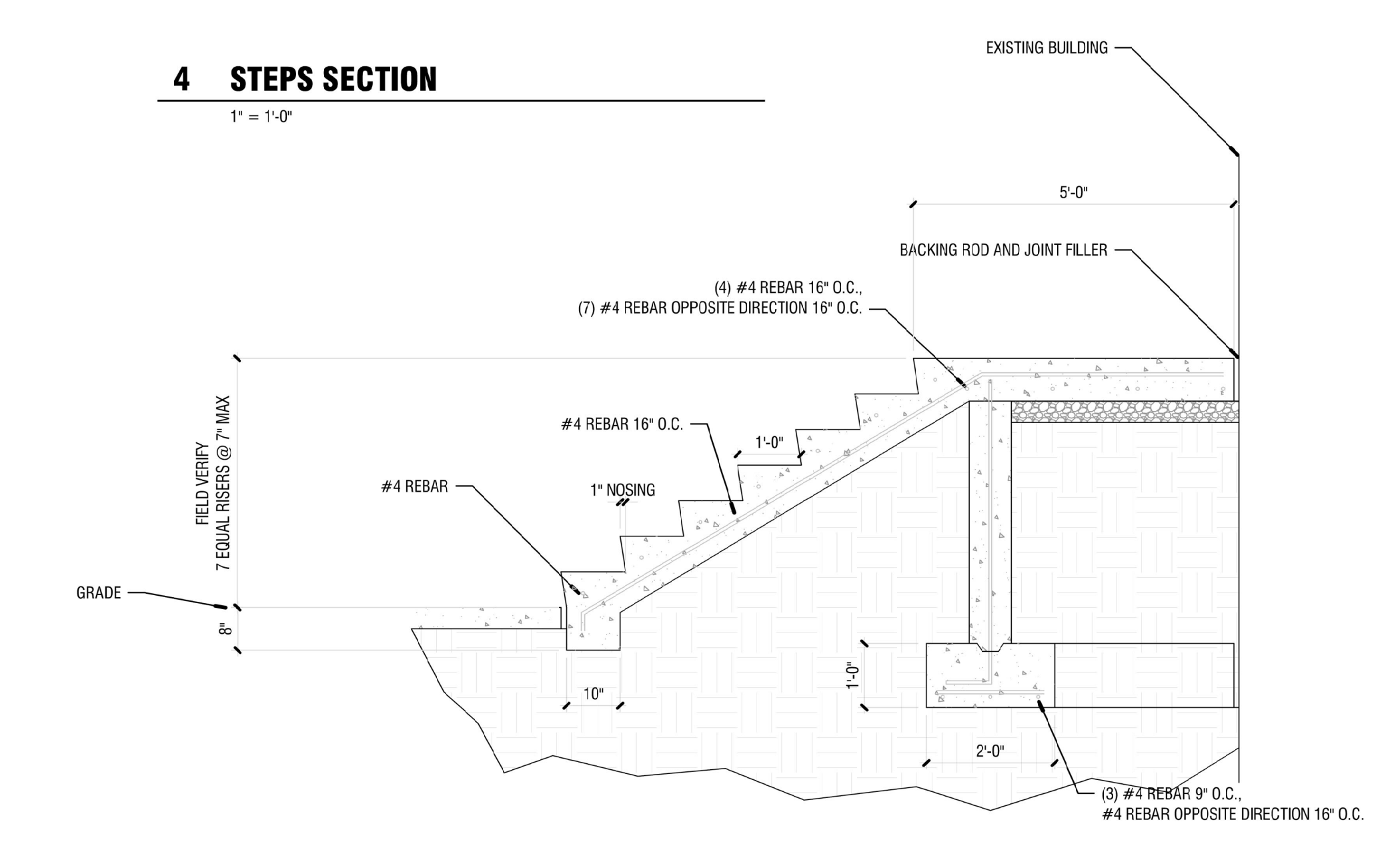

3 STEPS SECTION
1/2" = 1'-0"

REVISIONS		
Number	Date	Remarks
1	08.11.23	REVISED PER CITY'S COMMENTS
2	12.22.23	REVISED WATERPROOFING, ROOF, CORNICE, WINDOWS, ATTIC STAIR
3	02.09.24	REVISED ADDED STRUCTURAL DRAWINGS

CONSULTANTS

CARTER WATKINS ASSOCIATES ARCHITECTS, INC.
 POST OFFICE BOX 1064
 137 EAST WASHINGTON STREET
 MONROE, GEORGIA 30655
 Fax: 770-267-1064
 email@carterwatkins.com www.carterwatkins.com

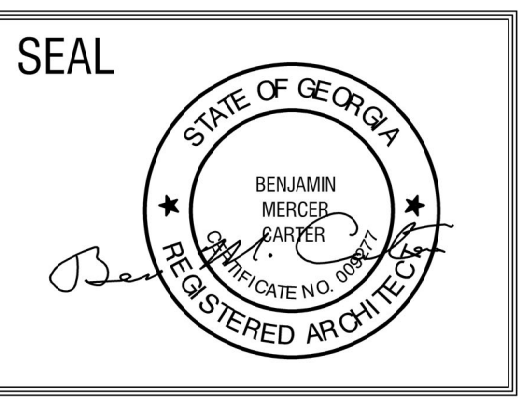

DALLAS CITY HALL BUILDING RENOVATIONS
 11 COURTHOUSE SQUARE,
 DALLAS, GA 30132

SHEET TITLE:
 NEW SIDE ENTRY STEPS AND SECTIONS
 PRINTED:

NUMBER:
SUB 1

PROJECT: DALLAS CITY HALL PRINTED DATE: 11/18/24 This document is the property of Carter Watkins Associates. Reproduction or any form is prohibited under Federal Copyright Laws.